



TRAFFIC COMMISSION MEETING AGENDA
CITY HALL COUNCIL CHAMBERS – September 19, 2024 – 4:00 P.M.

I. Meeting called to order – Roll Call

II. Approval of minutes from previous meeting (June 6, 2024)

III. Consent Item(s)

IV. Old Business

None.

V. New Business

- 1) Consider a request (24-46) from a citizen at NW Euclid Ave and NW Compass Dr.
- 2) Consider a request (24-47) from Bruce Rucker for a No Parking Sign on NW Chesley Dr.
- 3) Consider a request (24-48) from Fernan Sustaita to remove Yield Sign at NW Willow Creek
- 4) Consider a request (24-49) from Angel Sierra to install an Autistic Child Sign at 2416 SW Washington Ave
- 5) Consider a request (24-51) from Justin Martin to install a Stop or Yield Sign at NW Newgate and Allison Lane
- 6) Consider a request (24-52) for an Autistic Child sign at 6902 NW Cheyenne Dr.
- 7) Consider a request (24-53) for an Autistic Child sign at 2618 SW B Ave.
- 8) Consider a request (24-54) from Jaqueline Smith for a STOP sign at Sedalia Ave.
- 9) Consider a request (24-55) for a No Parking Sign at 2502 SW Wolf Ave.

VI. Audience Participation

VII. Adjournment



The City of Lawton encourages participation from all of its citizens. If participation at any public meeting is not possible due to a disability, please notify the City Clerk at (580) 581-3305 at least 48 hours prior to the scheduled meeting to make the necessary accommodations. The City may waive the 48 hour rule if signing interpreters for the deaf are not necessary.

TRAFFIC COMMISSION MINUTES

CITY HALL COUNCIL CHAMBERS

June 6, 2024 – 4:00 P.M.

I. Meeting called to order – Roll Call

David Means called the meeting to order at 4:01 p.m. in the City Hall Council Chambers (212 SW 9th St.). The meeting notice and agenda were posted on the City Hall (212 SW 9th St.) bulletin board as required by State law.

MEMBERS PRESENT: David Means, David Wood, Ted Warkentin, Mayoan Santana

ALSO, PRESENT BJ Hawkins, Traffic Engineer Consultant, Shanie Day, Traffic Commission Secretary, Sandra Malicoat, Traffic Commission Secretary, Joe Painter, City Engineer

MEMBERS ABSENT: Willie Smith, Hershel Kuykendall

II. Approval of minutes from previous meeting (February 15, 2024) MOVED BY Wood; SECOND BY: Warkentin; to accept the minutes as written. AYE: Means, Wood, Santana, Warkentin NAY: None; ABSTAIN: None

III. Consent Item(s)

None

IV. Old Business

None

V. New Business

- 1) Consider request (24-38) from Sharon Cheatwood. Citizen requesting a STOP sign be installed at the corner of NW 22nd St and NW Baltimore Ave. Citizen states that there is a current STOP sign at 22nd running North and South, but she is requesting East and West direction STOP sign on Baltimore also, due to this corner being a Lawton Public School bus stop intersection.

Action Recommended by Staff: Deny request. The subject intersection is located approximately 1 block west of Sheridan Road and approximately 2 blocks east of NW 23rd Street, both of which are east/west stop controlled. The intersection has low volume, low speed traffic with plenty of sight distance.

MOVED BY: Warkentin; **SECOND BY:** Wood, to deny request to install STOP signs at the corner of NW 22nd St and NW Baltimore Ave.

AYE Means, Wood, Santana, Smith; **NAY:** None; **ABSTAIN:** None

- 2) Consider a request (24-39) from Valarey Claflin for an Autistic Child Sign at 2212 NW 26th St.

Staff recommendation is to approve the request for the installation of an AUTISTIC CHILD sign in front of residence. Child's physician provided documentation of the diagnosis.

MOVED BY: Warkentin; **SECOND BY:** Wood; to approve request to install AUTISTIC CHILD sign in front of residence.

AYE: Means, Wood, Warkentin, Santana; **NAY:** None; **ABSTAIN:** None

- 3) Consider request (24-40) from Matt Lepien. Citizen states that on the west side of the Comanche County Courthouse on 6th Street, there is a crosswalk. Matt has heard many complaints of people almost getting hit by a car as they are crossing the road.

Staff recommendation is to approve request. It is recommended that the southbound pedestrian crossing sign be removed, and two (one northbound and one southbound) Rectangular Rapid Flashing Beacon (RRFB) Pedestrian Crosswalk System signs be installed. The signs are solar powered and only flash when activated by a pedestrian. The RRFB flashes rapidly and has been proven to improve driver yield rate by up to 96%.

MOVED BY: Santana; **SECOND BY:** Wood; to accept staff recommendation to remove pedestrian crossing sign and install Rectangular Rapid Flashing Beacon Pedestrian Crosswalk System signs.

AYE Means, Wood, Warkentin, Santana; **NAY:** None; **ABSTAIN:** None

- 4) Consider a request (24-41) from Bill Armstrong. The applicant indicates that speeding and running STOP signs is a consistent issue near his house. Odd configuration of intersections confuses drivers who ignore stops and have run into his yard. One vehicle hit his tree and flipped vehicle in his driveway.

Staff recommendation is to approve request. There is an existing STOP sign ½ block west in front of the citizens residence. Traffic Engineer recommended the installation of a STOP AHEAD sign east of NW 40th Street to further inform drivers of the upcoming westbound stop control. The intersection of Meadow Brook Drive and NW 40th is confusing and would be a great candidate for a single lane roundabout.

MOVED BY: Wood; **SECOND BY:** Warkentin; to approve installation of STOP sign east of NW 40th and Meadowbrook Drive.

AYE: Means, Wood, Warkentin, Santana; **NAY:** None; **ABSTAIN:** None

- 5) Consider a request (24-42) Citizen is requesting a STOP sign or a YIELD sign at the intersection of W Gore Blvd & SW 74th Street. Citizen is concerned about the construction on Gore Blvd. and people are not stopping for on-coming traffic as they turn onto Gore Blvd from 74th Street

Staff recommendation is to have City staff install a Temporary STOP sign on NW 74th Street at Gore Blvd. as soon as possible until construction is complete.

MOVED BY: Wood; **SECOND BY:** Warkentin; approval to install a Temporary STOP sign on NW 74th and Gore Blvd.

AYE: Means, Wood, Warkentin, Santana; **NAY:** None; **ABSTAIN:** None

- 6) Consider a request (24-43) Citizen states that at one point there was a “Dead End” or “No Exit” sign at the corner of Tomlin Circle and Homestead Drive. He states a couple of years ago there was construction done at that intersection and they had to remove the sign during construction and have never put another sign up. Citizen is asking for a Dead End or No Entry sign to be placed again at this intersection.

Staff recommendation is to approve installation of “DEAD END” or “NO OUTLET” sign at this location.

MOVED BY: Wood; **SECOND BY:** Warkentin; to install DEAD END or NO OUTLET sign at the corner of Tomlinson Circle and Homestead Drive.

AYE: Means, Wood, Warkentin, Santana; **NAY:** None; **ABSTAIN:** None

- 7) Consider a request (24-44) to review crosswalks at Douglas Learning Center at 102 E. Gore Blvd. The school zone flashers have been disabled at LPS request and we have received several requests to repaint the crosswalks, but I am hesitant due to no school zone warning/20 Mph protection. Pedestrians have crossing access at E. Gore & Railroad.

Staff recommendation is to deny request to restripe crosswalks. There are no established north/south wheelchair ramps or connecting sidewalks. Additionally, there is a north/south signalized crossing one block west at Railroad Street. I would recommend removing the non-operational school zone flasher signs, SCHOOL ZONE CROSSING signs, and END SCHOOL ZONE signs to not confuse drivers.

MOVED BY: Wood; **SECOND BY:** Warkentin; to deny restriping of crosswalks.

AYE: Means, Wood, Warkentin, Santana; **NAY:** None; **ABSTAIN:** None

- 8) Consider a request (24-45) to remove the traffic signals at the intersection of West Gore Boulevard and 4th Street and install STOP signs on 4th Street at West Gore Boulevard.

Staff recommendation is to approve request to remove the existing traffic signal at Gore Boulevard and 4th Street. Traffic signal warrant analyses were conducted which indicated that the intersection does not come close to satisfying the 8-hour, 4-hour, or peak hour vehicular volume warrants. It is recommended that northbound and southbound STOP signs be installed on 4th Street with supplemental "CROSS TRAFFIC DOES NOT STOP" signs installed below. (Figure 2.)

MOVED BY: Warkentin; **SECOND BY:** Wood; approval to remove signal lights at 4th St and Gore Blvd.

AYE: Means, Wood, Warkentin, Santana; **NAY:** None; **ABSTAIN:** None

VI. Audience Participation - None

VII. Adjournment

4:29p.m.

The City of Lawton encourages participation from all of its citizens. If participation at any public meeting is not possible due to a disability, please notify the City Clerk at (580) 581-3305 at least 48 hours prior to the scheduled meeting to make the necessary accommodations. The City may waive the 48-hour rule if signing interpreters for the deaf are not necessary.



TRAFFIC ISSUE REQUEST ENGINEERING DEPARTMENT

Administrative Office

Mailing Address – 212 SW 9th Street, Lawton, OK 73501
Shipping Address – 2202 SW 3rd Street, Lawton, OK 73501
Phone (580) 581-3410 • Fax (580) 581-3421
www.cityof.lawton.ok.us

Requested by: Citizen thru iHelp portal	Request Number: 24-46
Address: N/A	Date Request Received: 28 May 2024
City, State, Zip: 73501	Phone: N/A
Request: Citizen states that the intersection of NW Euclid Ave and NW Compass needs to be a 4-way Stop. NW Euclid Avenue has Stop Signs. Most people assume it's a 4-way stop. They will run the stop sign and pull out in front of people traveling on NW Compass Avenue.	
Description of Intersection / Location: NW Euclid Ave & NW Compass Ave	
Accident Report Listing: N/A	
WARRANTS (MUTCD/City Code/City Policy): N/A	
Previous Action: N/A	
Previous Traffic Commission Recommendation(s): N/A	
Previous City Council Decision(s): N/A	
Action Recommended by Staff: Deny the request to install a STOP sign on NW Compass Ave. Installing All-Way Stop Control requires meeting the warrant in the Manual of Uniform Traffic Control Devices (MUTCD); engineering judgment alone is not enough. (Ref. Sections 2B.07 and 2B.16 in MUTCD). Crash data from the OSHO interactive map and traffic volume from ODOT do not fulfill the requirement to change the intersection control to an all-way stop. Sight distance does not appear to be limited from Google Imagery and Streetview. Instead, install "CROSS TRAFFIC DOES NOT STOP" (W4-4P) plaques with the existing STOP signs on NW Euclid Ave approaches. These plaques will clarify to the drivers on NW Euclid Ave that the intersection is not an all-way stop and that the traffic on NW Compass Ave has the right of way. After installing the W4-4P plaques if the issue persists, a minimum 13-hour traffic count study is recommended to evaluate if an all-way stop control is warranted.	
Traffic Engineer: Jignesh Thakkar, PE (TX, GA), PTOE	
Considered by Traffic Commission:	
Considered by City Council:	

9-19-24

Street View Link: https://www.google.com/maps/@34.615243,-98.4709073,3a,75y,155.99h,73.5t/data=!3m7!1e1!3m5!1ssSs-F-ilvhb-Bd-hzWPSzw!2e0!6shttps:%2F%2Fstreetviewpixels-pa.googleapis.com%2Fv1%2Fthumbnail%3Fcb_client%3Dmaps_sv.tactile%26w%3D900%26h%3D600%26pitch%3D16.501936379184073%26panoid%3DsSs-F-ilvhb-Bd-hzWPSzw%26yaw%3D155.9884403598451!7i16384!8i8192?coh=205410&entry=ttu

Recommendation: Deny the request to install stop sign on Euclid Ave. This intersection does not meet all the warrants to change it to an all-way stop control intersection.

To address the issue of people running the stop sign, either or both of the following recommendations could be implemented.

1. Install Stop ahead (W3-1) signs on Euclid Avenue.
2. Paint the STOP line on the street.
3. Install Cross Traffic Do Not Stop plaque.

Internal Analysis:

~~All Way Stop Control requires meeting the warrant to install, engineering judgment alone is not enough to install an All Way Stop Control.~~

- ~~A. There has been no reported crash in the last three years in OHSO Interactive Crash Maps.~~
- ~~B. Sight distance looks okay.~~
- ~~C. AADT in Compass drive is 990 (2020) and 2100 (2020) in far east end of Euclid Ave. It does not meet the volume requirement. The section 2B.07 and 2B.16 in MUITCD is reviewed.~~

Section 2B.16 All-Way Stop Control Warrant D: 8-Hour Volume (Vehicles, Pedestrians, Bicycles)

Option:

- 01 All-way stop control may be installed at an intersection where an engineering study indicates:
 - A. The combined motor vehicle, bicycle, and pedestrian volume entering the intersection from the major-street approaches is at least 300 units per hour for each of any 8 hours of a typical day; and
 - B. The combined motor vehicle, bicycle, and pedestrian volume entering the intersection from the minor-street approaches is at least 200 units per hour for each of any of the same 8 hours.
- 02 If the 85th-percentile approach speed of the major-street traffic exceeds 40 mph, the minimum vehicular volume warrants may be reduced to 70 percent of the values given in Items A and B in Paragraph 1 of this Section.

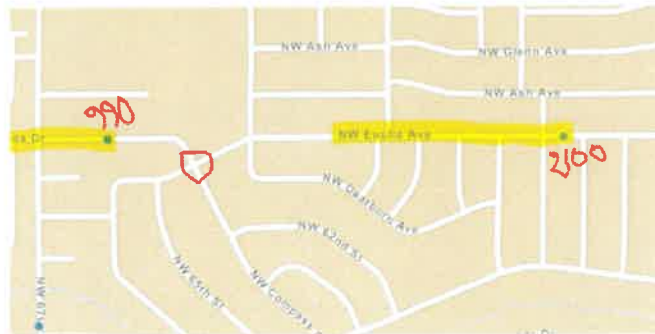

~~People disregards stop signs on Euclid Ave and pull out on Compass Ave. To mitigate that, either or both the following recommendations could be implemented.~~

- ~~1. Install Stop ahead (W3-1) sign on Euclid Avenue.~~
- ~~2. Paint STOP line on the street.~~

MUTCD section 2B.08 is relevant to this recommendation. The screenshot of that section is the following.

Section 2B.08 Right-of-Way Intersection Control Considerations

Guidance:

- 01 *Before converting to a more restrictive form of right-of-way control at an unsignalized intersection, the following alternative treatments to address safety, operational, or other concerns should be among those to be considered:*
- A. Where yield or stop controlled, installing Yield Ahead or Stop Ahead signs on the appropriate approaches to the intersection;*
 - B. Removing parking on one or more approaches;*
 - C. Removing sight distance obstructions;*
 - D. Installing signs along the major street to warn road users approaching the intersection;*
 - E. Relocating the stop line(s) and making other changes to improve the sight distance at the intersection;*
 - F. Installing measures designed to reduce speeds on the approaches;*
 - G. Installing an Intersection Control Beacon (see Section 4S.02) or Stop Beacon (see Section 4S.05) at the intersection to supplement STOP sign control;*
 - H. Installing a Warning Beacon (see Section 4S.03) on warning signs in advance of a stop-controlled intersection on major-street and/or minor-street approaches;*
 - I. Adding one or more lanes on a minor-street approach to reduce the number of vehicles per lane on the approach;*
 - J. Revising the geometrics at the intersection to channelize vehicular movements and reduce the time required for a vehicle to complete a movement, which could also assist pedestrians;*
 - K. Revising the geometrics at the intersection to add pedestrian median refuge islands and/or curb extensions;*
 - L. Installing roadway lighting if a disproportionate number of crashes occur at night;*
 - M. Restricting one or more turning movements on a full-time or part-time basis if alternate routes are available;*



TRAFFIC ISSUE REQUEST

ENGINEERING DEPARTMENT

Administrative Office

Mailing Address – 212 SW 9th Street, Lawton, OK 73501
Shipping Address – 2202 SW 3rd Street, Lawton, OK 73501
Phone (580) 581-3410 • Fax (580) 581-3421

www.cityof.lawton.ok.us

Requested by: Bruce Rucker	Request Number: 24-47
Address: 806 NW Hampton Court	Date Request Received: 4 June 2024
City, State, Zip: Lawton OK	Phone: 580-284-9952
Request: Citizen requests that a No Parking Sign be installed on NW Chesley Dr @ NW 82 nd St.	
Description of Intersection / Location: NW Chesley Dr and NW 82 nd St.	
Accident Report Listing: N/A	
WARRANTS (MUTCD/City Code/City Policy): N/A	
Previous Action: N/A	
Previous Traffic Commission Recommendation(s): N/A	
Previous City Council Decision(s): N/A	
Action Recommended by Staff: Deny the request. According to the 2023 Oklahoma Statutes Title, no person shall park a vehicle within 30 feet upon approaching a stop sign. This rule should be adequate to protect the residential street from any parked car at the NW Chesley Dr and NW 82nd St intersection. A similar street, NW Cheswick Ave, and NW 82nd St is reviewed for an example and does not have a NO PARKING sign.	
Traffic Engineer: Jignesh Thakkar, PE (TX, GA), PTOE	
Considered by Traffic Commission:	
Considered by City Council:	

9-19-24

Street View Link: https://www.google.com/maps/@34.6166167,-98.4916686,3a,90y,261.96h,92.32t/data=!3m7!1e1!3m5!1sQTmQy1nCTAGKttrRqFYrQ!2e0!6shttps://pa.googleapis.com/%2Fv1/%2Fthumbnail%3Fcb_client%3Dmaps_sv.tactile%26w%3D900%26h%3D600%26pitch%3D-2.3184551784157463%26panoid%3DQTmQy1nCTAGKttrRqFYrQ%26yaw%3D261.9643765991744!7i16384!8i8192?coh=205410&entry=ttu

Recommendation: Deny the request. No parking within 30 ft distance from the STOP sign rule should be enough to clear the intersection.

Internal Analysis: The no parking zone is not adequate to install a NO PARKING sign, The satellite view and relevant rules are attached. Similar street like Micklegate Blvd on NW 82nd St does not have any NO PARKING sign.



2023 Oklahoma Statutes
Title 47. Motor Vehicles
§47-11-1003. Stopping, standing or parking prohibited in specified places.

Universal Citation: 47 OK Stat § 11-1003 (2023) [?](#)

[< Previous](#)

[Next >](#)

A. Except as otherwise provided in subsection B of this section, no person shall stop, stand or park a vehicle, except when necessary to avoid conflict with other traffic or in compliance with law or the directions of a police officer or traffic-control device, in any of the following places:

1. On a sidewalk;
2. In front of a public or private driveway;
3. Within fifteen (15) feet of a fire hydrant, or if in an area serviced by a volunteer fire department, within thirty (30) feet of a fire hydrant if the governing body of the area so adopts by ordinance;
4. Within an intersection;
5. On a crosswalk;
6. Within twenty (20) feet of a crosswalk at an intersection;
7. Within thirty (30) feet upon the approach to any flashing beacon, stop sign or traffic-control signal located at the side of a roadway;



TRAFFIC ISSUE REQUEST
ENGINEERING DEPARTMENT

Administrative Office

Mailing Address – 212 SW 9th Street, Lawton, OK 73501
 Shipping Address – 2202 SW 3rd Street, Lawton, OK 73501
 Phone (580) 581-3410 • Fax (580) 581-3421
www.cityof.lawton.ok.us

Requested by: Fernan Sustaita	Request Number: 24-48
Address: 7602 NW Micklegate Blvd	Date Request Received: 05 June 24
City, State, Zip: Lawton OK	Phone: 832-491-8380
Request: Citizen requesting to remove the Yield sign and replace it with a Stop sign at the intersection of NW Willow Creek Dr & NW Micklegate Blvd.	
Description of Intersection / Location: NW Willow Creek Dr and NW Micklegate Blvd	
Accident Report Listing: N/A	
WARRANTS (MUTCD/City Code/City Policy): N/A	
Previous Action: N/A	
Previous Traffic Commission Recommendation(s): N/A	
Previous City Council Decision(s): N/A	
<p>Action Recommended by Staff: Accept the request to remove the Yield sign and replace it with a Stop sign.</p> <p>At the intersection, Willow Creek Dr meets Micklegate Blvd, where the curved road creates an obstacle in the sight distance. Nearby Willow Creek Park attracts pedestrian and bicycle traffic. Replacing the Yield sign with the Stop sign will increase the safety of this intersection.</p>	
Traffic Engineer: Jignesh Thakkar, PE (TX, GA), PTOE	
Considered by Traffic Commission:	
Considered by City Council:	

9-19-24

Street View Link: https://www.google.com/maps/@34.6189493,-98.4864575,3a,43y,242.87h,86.12t/data=!3m7!1e1!3m5!1sgPSjLybyaxGQ2hh1Wgm3Gw!2e0!6shttps://pa.googleapis.com%2Fv1%2Fthumbnail%3Fcb_client%3Dmaps_sv.tactile%26w%3D900%26h%3D600%26pitch%3D3.8767652186580364%26panoid%3DgPSjLybyaxGQ2hh1Wgm3Gw%26yaw%3D242.87486473537137!7i16384!8i8192?coh=205410&entry=ttu

Recommendation: Deny the request. The intersection does not meet the requirements to change the sign from YIELD to STOP.

Internal Review: Sight distance and crash history does not warrant changing the YIELD sign to STOP. The relevant MUTCD section is the following:

Section 2B.11 Minor Road Stop Control

Guidance:

- 01 Stop control on the minor-road approach or approaches to an intersection should be considered when engineering judgment indicates that one or more of the following conditions exist:
 - A. A restricted view exists that requires road users to stop in order to adequately observe conflicting traffic on the through street or highway.
 - B. Crash records indicate that:
 - 1. For a four-leg intersection, there are three or more reported crashes in a 12-month period or six or more reported crashes in a 36-month period. The crashes should be susceptible to correction by installation of minor-road stop control. **3+ in 1 year**
 - 2. For a three-leg intersection, there are three or more reported crashes in a 12-month period or five or more reported crashes in a 36-month period. The crashes should be susceptible to correction by installation of minor-road stop control. **5+ in 3 years**
 - C. The intersection is of a lower functional classification road with a higher functional classification road.
 - D. Conditions that previously supported the installation of all-way stop control no longer exist.
- 02 On low-volume rural roads, a STOP sign should be considered at an intersection where engineering judgment indicates that Item C in Paragraph 1 of this Section is applicable or where the intersection has inadequate sight distance for the operating vehicle speeds.

Moreover, YIELD sign is applicable in vehicle+bicycle+pedestrian volume less than 1800 per day or 140 units in the peak hour. The AADT is 960 (2020) in Willow Creek Dr. The screenshot from ODOT AADT map is attached.





TRAFFIC ISSUE REQUEST
ENGINEERING DEPARTMENT

Administrative Office

Mailing Address – 212 SW 9th Street, Lawton, OK 73501
 Shipping Address – 2202 SW 3rd Street, Lawton, OK 73501
 Phone (580) 581-3410 • Fax (580) 581-3421
www.cityof.lawton.ok.us

Requested by: Angel Sierra	Request Number: 24-49
Address: 2416 SW Washington Ave	Date Request Received: 6 June 24
City, State, Zip: Lawton, OK	Phone: 580-284-1853
<p>Request: Citizen request to install an Autistic Child Sign and Deaf Child Sign on her road. Medical documentation has been supplied by the parent and attached to this request. Citizen is also requesting a Dead-End sign on Washington Avenue due to too much traffic.</p>	
<p>Description of Intersection / Location: 2416 SW Washington Avenue</p>	
<p>Accident Report Listing: N/A</p>	
<p>WARRANTS (MUTCD/City Code/City Policy): N/A</p>	
<p>Previous Action: N/A</p>	
<p>Previous Traffic Commission Recommendation(s): N/A</p>	
<p>Previous City Council Decision(s): N/A</p>	
<p>Action Recommended by Staff: Warning signs with Autistic Child or Deaf Child are specific use non-standard signs that are not covered under the Manual of Uniform Traffic Control Devices (MUTCD). Since these signs are non-standard, drivers may not have a clear understanding of what to interpret these signs and may not necessarily increase safety. However, a few municipalities in other states have installed similar non-standard signs in special cases with supporting medical documentation. If installed, the sign should read “CHILD WITH AUTISM”.</p> <p>SW Washington Ave terminates just west of SW 24th St. Installation of DEAD-END with arrow (W14-1a) plaques on the existing post with the SW Washington Ave street name sign at SW 24th St intersection is recommended. This may reduce traffic on SW Washington Ave by eliminating drivers that enter the street assuming that the street continues further west.</p>	
<p>Traffic Engineer: Jignesh Thakkar, PE (TX, GA), PTOE</p>	
<p>Considered by Traffic Commission:</p>	
<p>Considered by City Council:</p>	

9-19-24

Street View Link: https://www.google.com/maps/@34.593074,-98.425942,3a,75y,272.72h,84.55t/data=!3m7!1e1!3m5!1s5zfKH7qQew3q0CaiOKk8Iw!2e0!6shttps:%2F%2Fstreetviewpixels-pa.googleapis.com%2Fv1%2Fthumbnail%3Fcb_client%3Dmaps_sv.tactile%26w%3D900%26h%3D600%26pitch%3D5.452609034516229%26panoid%3D5zfKH7qQew3q0CaiOKk8Iw%26yaw%3D272.7228405589825!7i16384!8i8192?coh=205410&entry=ttu

Recommendation: Deny the CHILD WITH AUTISM sign.
Install DEAD END (W14-1) sign at the entrance of SW Washington Ave.

Internal Analysis: CHILD WITH AUTISM sign is non-compliant with MUTCD. Installing the DEAD END sign may reduce the traffic in that area.

~~There are two options for the DEAD-END sign. Either install the DEAD-END (W14-1) sign at the entrance of SW Washington Ave or install the DEAD-END ARROW (W14-1a) sign with the Washington Ave street name sign. For simplicity W14-1 is recommended.~~

University of Connecticut [does not recommend](#) a similar sign – CHILDREN AT PLAY. This type of sign may create a false sense of safety, clutter the street, may lead the driver to believe there is no autistic child in areas without the signs. Studies have shown this type of signs do not reduce speed or make driver more observant. Children may face danger when go too far away from the sign.

There are examples of installation of this sign in [Illinois](#), [New York](#). New York DOT created a [CHILD WITH AUTISM plaque](#) to use with Pedestrian (W11-2) sign. In case of wording, “Child with autism” is preferred over “Autistic Child” in this type of sign.



TRAFFIC ISSUE REQUEST
ENGINEERING DEPARTMENT

Administrative Office

Mailing Address – 212 SW 9th Street, Lawton, OK 73501
Shipping Address – 2202 SW 3rd Street, Lawton, OK 73501
Phone (580) 581-3410 • Fax (580) 581-3421
www.cityof.lawton.ok.us

Requested by: Justin Martin	Request Number: 24-51
Address: 601 NW Newgate Drive	Date Request Received: 28 July 2024
City, State, Zip: Lawton OK	Phone: N/A
<p>Request: Citizen is requesting a Stop sign or Yield sign be installed for the following intersections: #1. NW Newgate Dr & NW Taylors Landing #2. NW Allison Lane & NW Micklegate Blvd.</p> <p>(this is the second Citizen request @ Mickelgate Blvd. (#24-48) but not sure if it is the exact same location)</p>	
Description of Intersection / Location:	
Accident Report Listing: N/A	
WARRANTS (MUTCD/City Code/City Policy): N/A	
Previous Action: N/A	
Previous Traffic Commission Recommendation(s): N/A	
Previous City Council Decision(s): N/A	
<p>Action Recommended by Staff: Install a Yield Sign on NW Allsion Ln. Horizontal curves exist on both streets just prior to the intersection, and the view for the left-turning traffic on NW Allison Ln is obstructed by a fence. Installing a Yield sign on NW Allison Ln may improve the safety of this intersection.</p> <p>Deny the request to install a Yield or Stop sign on NW Newgate Dr. The sight distance from the street view appears adequate. Crash data and traffic volume are okay to run this intersection in “No Intersection Control” (ref Section 2B.09 and 2B.10 of the Manual of Uniform Traffic Control Devices (MUTCD)).</p>	
Traffic Engineer: Jignesh Thakkar, PE (TX, GA), PTOE	
Considered by Traffic Commission:	

9-19-24

Considered by City Council:

Street View Link:

1. NW Newgate Drive and NW Taylors Landing

https://www.google.com/maps/@34.6139146,-98.4904855,3a,75y,180.15h,76.78t/data=!3m7!1e1!3m5!1sK5opo_x9xaqIRpeg2fQ_wA!2e0!6shttps:%2F%2Fstreetviewpixels-pa.googleapis.com%2Fv1%2Fthumbnail%3Fcb_client%3Dmaps_sv.tactile%26w%3D900%26h%3D600%26pitch%3D13.217810088451074%26panoid%3DK5opo_x9xaqIRpeg2fQ_wA%26yaw%3D180.14745157470762!7i16384!8i8192?coh=205410&entry=ttu

2. NW Allison Lane and NW Mickelgate Blvd.

https://www.google.com/maps/@34.615596,-98.4878788,3a,90y,59.83h,84.68t/data=!3m7!1e1!3m5!1sUrPyxXdOIQ1hYXshDUXTCA!2e0!6shttps:%2F%2Fstreetviewpixels-pa.googleapis.com%2Fv1%2Fthumbnail%3Fcb_client%3Dmaps_sv.tactile%26w%3D900%26h%3D600%26pitch%3D5.322437196611318%26panoid%3DUrPyxXdOIQ1hYXshDUXTCA%26yaw%3D59.8275990266913!7i16384!8i8192?coh=205410&entry=ttu

Recommendation: Install a Yield Sign on NW Allison Lane. Both streets are curved before the intersection, and a fence obstructs the left-turning traffic from NW Allison Ln. Installing a Yield sign on NW Allison Ln will increase the safety of this intersection.

Deny the request to install a Yield or Stop sign on NW Newgate Drive. Section 2B.09 and 2B.10 are considered from the Manual of Uniform Traffic Control Devices (MUTCD) to turn the no-control intersection into a Yield Control intersection. The sight distance from the street view appears adequate. Crash data and traffic volume are okay to run this intersection in “No Intersection Control.”

Internal Analysis: Numeric data like crash data, traffic volume are okay to run both intersections in “No Intersection Control”. Relevant MUTCD section screenshot is attached. Considering sight distance, yield sign is recommended in NW Allison Lane.

Section 2B.09 No Intersection Control

Guidance:

01 *The decision not to use intersection control should be based on engineering judgment.*

Option:

- 02 The following factors may be considered:
- A. Intersection sight distance is adequate on all approaches.
 - B. All approaches to the intersection are a single lane and there are no separate turn lanes.
 - C. The combined motor vehicle, bicycle, and pedestrian volume (existing or projected) entering the intersection from all approaches averages less than 1,000 units per day or 80 units in the peak hour.
 - D. There are no marked crosswalks or bicycle lanes on any approach.
 - E. None of the approaches to the intersection are for a through highway, main road, or higher functional classification.
 - F. The angle of intersection is between 90 and 75 degrees.
 - G. The functional classification of the intersecting streets is either the intersection of two local streets or the intersection of a local street with a collector street.

Section 2B.10 Yield Control

Guidance:

01 *At intersections where a full stop is not necessary at all times, consideration should first be given to using less restrictive measures such as YIELD signs.*

02 *Yield control should be considered when engineering judgment indicates that all of the following conditions exist:*

- A. *Intersection sight distance is adequate on the approaches to be controlled by YIELD signs.*
- B. *All approaches to the intersection are a single lane and there are no separate turn lanes.*
- C. *One of the following crash-related criteria applies:*
- D. *For changing from no intersection control to yield control, there have been two or more reported crashes in the previous 12 months that are susceptible to correction by the installation of a YIELD sign.*
- E. *For changing from minor road stop control to yield control, there have been two or fewer reported crashes in the previous 12 months.*
- F. *The combined motor vehicle, bicycle, and pedestrian volume entering the intersection averages less than 1,800 units per day or 140 units in the peak hour.*
- G. *The angle of intersection is between 90 and 75 degrees.*
- H. *The functional classification of the intersecting streets is either the intersection of two local streets or the intersection of a local street with a collector street.*



TRAFFIC ISSUE REQUEST **ENGINEERING DEPARTMENT**

Administrative Office

Mailing Address – 212 SW 9th Street, Lawton, OK 73501
Shipping Address – 2202 SW 3rd Street, Lawton, OK 73501
Phone (580) 581-3410 • Fax (580) 581-3421

www.cityoflawton.ok.us

Requested by: Mr. & Mrs. Craig	Request Number: 24-52
Address: 6202 NW Cheyenne Drive	Date Request Received: 09 August 2024
City, State, Zip: Lawton, OK	Phone:
Request: Citizen request to install an Autistic Child Sign. Medical documentation has been supplied by the parent and attached to this request.	
Description of Intersection / Location: 6202 NW Cheyene Drive	
Accident Report Listing: N/A	
WARRANTS (MUTCD/City Code/City Policy): N/A	
Previous Action: N/A	
Previous Traffic Commission Recommendation(s): N/A	
Previous City Council Decision(s): N/A	
Action Recommended by Staff: Warning signs with Autistic Child or Deaf Child are specific use non-standard signs that are not covered under the Manual of Uniform Traffic Control Devices (MUTCD). Lawton City Code 23-2-202 states that all traffic signs "shall conform to the latest edition of the "Manual on Uniform Traffic Control Devices for Streets and Highways" published by the Federal Highway Administration." Since these signs are non-standard, drivers may not have a clear understanding of what to interpret these signs and may not necessarily increase safety. However, a few municipalities in other states have installed similar non-standard signs in special cases with supporting medical documentation. NW 40th St in Lawton has two HANDICAPPED CHILD AREA signs. There is no specific process defined in the Lawton City Code for installation of non-standard signs. If installed, the sign should read "CHILD WITH AUTISM".	
Traffic Engineer: Jignesh Thakkar, PE (TX, GA), PTOE	
Considered by Traffic Commission:	
Considered by City Council:	

9-19-24

Street View Link:

https://www.google.com/maps/place/6202+NW+Cheyenne+Ave,+Lawton,+OK+73505/@34.6257055,-98.4687452,3a,75y,226.46h,77.28t/data=!3m7!1e1!3m5!1sW-SGfu_tbKYlybr_ahCRiA!2e0!6shttps:%2F%2Fstreetviewpixels-pa.googleapis.com%2Fv1%2Fthumbnail%3Fcb_client%3Dmaps_sv.tactile%26w%3D900%26h%3D600%26pitch%3D12.720495894580608%26panoid%3DW-SGfu_tbKYlybr_ahCRiA%26yaw%3D226.46306791636982!7i16384!8i8192!4m6!3m5!1s0x87ad1e3a36e03c49:0x9df46a34c1da0a3e!8m2!3d34.6255532!4d-98.468921!16s%2Fg%2F11c4rsd9yk?coh=205410&entry=tu&g_ep=EgoyMDI0MDkwMi4xIKXMDSOASAFAQw%3D%3D

Recommendation: Lawton city code [23-2-202](#) states that all traffic signs "shall conform to the latest edition of the "Manual on Uniform Traffic Control Devices for Streets and Highways" published by the Federal Highway Administration." Warning signs with Autistic Children is specifically non-standard signs that is not covered under MUTCD. Since this sign is non-standard, drivers may not have a clear understanding of what to interpret the sign and may not necessarily increase safety. However, a few municipalities in other states have installed similar non-standard signs in special cases with supporting medical documentation. NW 40th St in Lawton has two HANDICAPPED CHILD AREA signs. Therefore, it is the Traffic Commission's discretion whether to install a MUTCD non-compliant sign. If installed, the sign should read "AREA OF CHILD WITH AUTISM".

However, NW 40th St has two HANDICAPPED CHILD AREA signs.

https://www.google.com/maps/@34.6328984,-98.4421021,3a,75y,207.29h,81.24t/data=!3m7!1e1!3m5!1sORExFG7YKj2ybzflA4JrVw!2e0!6shttps:%2F%2Fstreetviewpixels-pa.googleapis.com%2Fv1%2Fthumbnail%3Fcb_client%3Dmaps_sv.tactile%26w%3D900%26h%3D600%26pitch%3D8.761750860627103%26panoid%3DORExFG7YKj2ybzflA4JrVw%26yaw%3D207.29481297786106!7i16384!8i8192?coh=205410&entry=tu&g_ep=EgoyMDI0MDgyNy4wIKXMDSOASAFAQw%3D%3D

https://www.google.com/maps/@34.631542,-98.4425054,3a,69y,46.53h,85.53t/data=!3m7!1e1!3m5!1sVM5wlrTHpHFk4UeWZaxyA!2e0!6shttps:%2F%2Fstreetviewpixels-pa.googleapis.com%2Fv1%2Fthumbnail%3Fcb_client%3Dmaps_sv.tactile%26w%3D900%26h%3D600%26pitch%3D4.47462933662338%26panoid%3DVM5wlrTHpHFk4UeWZaxyA%26yaw%3D46.52932869780347!7i16384!8i8192?coh=205410&entry=tu&g_ep=EgoyMDI0MDgyNy4wIKXMDSOASAFAQw%3D%3D

Internal Analysis: Cheyenne Dr has already had a YIELD sign at the end of the road.



TRAFFIC ISSUE REQUEST **ENGINEERING DEPARTMENT**

Administrative Office

Mailing Address – 212 SW 9th Street, Lawton, OK 73501
Shipping Address – 2202 SW 3rd Street, Lawton, OK 73501
Phone (580) 581-3410 • Fax (580) 581-3421

www.cityof.lawton.ok.us

Requested by: Kameron Thompson	Request Number: 24-53
Address: 2618 SW B Avenue	Date Request Received: 19 August 2024
City, State, Zip: Lawton, OK 73505	Phone: 903-720-4045
Request: Autistic Child Sign	
Description of Intersection / Location:	
Accident Report Listing: N/A	
WARRANTS (MUTCD/City Code/City Policy): N/A	
Previous Action: N/A	
Previous Traffic Commission Recommendation(s): N/A	
Previous City Council Decision(s): N/A	
Action Recommended by Staff: Warning signs with Autistic Child or Deaf Child are specific use non-standard signs that are not covered under the Manual of Uniform Traffic Control Devices (MUTCD). Lawton City Code 23-2-202 states that all traffic signs "shall conform to the latest edition of the "Manual on Uniform Traffic Control Devices for Streets and Highways" published by the Federal Highway Administration." Since these signs are non-standard, drivers may not have a clear understanding of what to interpret these signs and may not necessarily increase safety. However, a few municipalities in other states have installed similar non-standard signs in special cases with supporting medical documentation. NW 40th St in Lawton has two HANDICAPPED CHILD AREA signs. There is no specific process defined in the Lawton City Code for installation of non-standard signs. If installed, the sign should read "CHILD WITH AUTISM".	
Traffic Engineer: Jignesh Thakkar, PE (TX, GA), PTOE	
Considered by Traffic Commission:	
Considered by City Council:	

9-19-24

Street View Link:

https://www.google.com/maps/place/2618+SW+B+Ave,+Lawton,+OK+73505/@34.6061593,-98.4305073,3a,75y,148.23h,78.11t/data=!3m7!1e1!3m5!1sYxqUYrVUHhugTpgYEO Nb9Q!2e0!6shttps:%2F%2Fstreetviewpixels-pa.googleapis.com%2Fv1%2Fthumbnail%3Fcb_client%3Dmaps_sv.tactile%26w%3D900%26h%3D600%26pitch%3D11.885472229346803%26panoid%3DYxqUYrVUHhugTpgYEO Nb9Q%26yaw%3D148.2320643141604!7i16384!8i8192!4m6!3m5!1s0x87ad1f053c954d6b:0x7e9e2ce686668a7a!8m2!3d34.6060054!4d-98.4305458!16s%2Fg%2F11crvnm61q?coh=205410&entry=tu&g_ep=EgoyMDI0MDgyNy4wIKXMDSoASAFQAw%3D%3D

Recommendation: Lawton city code 23-2-202 states that all traffic signs “shall conform to the latest edition of the "Manual on Uniform Traffic Control Devices for Streets and Highways" as published by the Federal Highway Administration”. Warning signs with Autistic Child is specifically use non-standard signs that is not covered under MUTCD. Since this sign is non-standard, drivers may not have a clear understanding of what to interpret the sign and may not necessarily increase safety. However, a few municipalities in other states have installed similar non-standard signs in special cases with supporting medical documentation. NW 40th St in Lawton has two HANDICAPPED CHILD AREA signs. If installed, the sign should read “AREA OF CHILD WITH AUTISM”.

Internal Analysis: Lawton city code chapter 23 and article 2 states to conform the traffic signs with MUTCD. The reference article is the following:

23-2-202 - Design and construction of traffic-control devices; manual of specifications.

All traffic-control signs, signals and devices shall conform to the latest edition of the "Manual on Uniform Traffic Control Devices for Streets and Highways" as published by the Federal Highway Administration. All signs and signals required hereunder for a particular purpose shall so far as practicable be uniform as to type and location throughout the city. All traffic-control devices so erected and not inconsistent with the provisions of state law or this chapter shall be official traffic-control devices.

However, NW 40th St has two HANDICAPPED CHILD AREA signs.

https://www.google.com/maps/@34.6328984,-98.4421021,3a,75y,207.29h,81.24t/data=!3m7!1e1!3m5!1sORExFG7YKj2ybzflA4JrVw!2e0!6shttps:%2F%2Fstreetviewpixels-pa.googleapis.com%2Fv1%2Fthumbnail%3Fcb_client%3Dmaps_sv.tactile%26w%3D900%26h%3D600%26pitch%3D8.761750860627103%26panoid%3DORExFG7YKj2ybzflA4JrVw%26yaw%3D207.29481297786106!7i16384!8i8192?coh=205410&entry=tu&g_ep=EgoyMDI0MDgyNy4wIKXMDSoASAFQAw%3D%3D

https://www.google.com/maps/@34.631542,-98.4425054,3a,69y,46.53h,85.53t/data=!3m7!1e1!3m5!1sVM5wlrTHpHFnK4UeWZaxyA!2e0!6shttps:%2F%2Fstreetviewpixels-pa.googleapis.com%2Fv1%2Fthumbnail%3Fcb_client%3Dmaps_sv.tactile%26w%3D900%26h%3D600%26pitch%3D4.47462933662338%26panoid%3DVM5wlrTHpHFnK4UeWZaxyA%26yaw%3D46.52932869780347!7i16384!8i8192?coh=205410&entry=tu&g_ep=EgoyMDI0MDgyNy4wIKXMDSoASAFQAw%3D%3D



TRAFFIC ISSUE REQUEST

ENGINEERING DEPARTMENT

Administrative Office

Mailing Address – 212 SW 9th Street, Lawton, OK 73501
Shipping Address – 2202 SW 3rd Street, Lawton, OK 73501
Phone (580) 581-3410 • Fax (580) 581-3421
www.cityof.lawton.ok.us

Requested by: Jacquelin Smith	Request Number: 24-54
Address: 904 SW Sedalia Avenue	Date Request Received: 22 August 2024
City, State, Zip: Lawton, OK 73501	Phone: 580284-4316
Request: Stop signs at both ends of Salinas Drive. It is a loop. Kids playing sign at the east end of Sedalia Avenue. There is kids playing sign on the west end of Sedalia Avenue.	
Description of Intersection / Location: Intersection of Salinas Avenue and Sedalia Drive. (Stop signs) East end of Sedalia Avenue Kids playing sign.	
Accident Report Listing: N/A	
WARRANTS (MUTCD/City Code/City Policy): N/A	
Previous Action: N/A	
Previous Traffic Commission Recommendation(s): N/A	
Previous City Council Decision(s): N/A	
Action Recommended by Staff: Install a Yield Sign on western opening of the SW Salinas Dr at 806 SW Sedalia Ave. According to OSHO interactive crash maps, there was a pedestrian crash in that intersection in April 2020. It appears in google street view that the view for the left-turning traffic on SW Salinas Dr may be obstructed by a tree. Installing a Yield on SW Salinas Dr may improve the safety of this intersection. Deny the request to install a Yield or Stop sign on eastern opening of the Salinas Dr. The sight distance from the street view appears adequate. According to OSHO interactive crash maps, there has been no crash in that intersection in the last 12 months. Considering the estimated traffic volume and crash data, this intersection can run in “No Intersection Control” (ref Section 2B.09 and 2B.10 of the Manual of Uniform Traffic Control Devices (MUTCD)). Deny the kids’ playing sign as it is not MUTCD compliant. According to Lawton city code 23-2-202, all traffic-control signs, signals and devices shall conform to the latest edition of the MUTCD.	
Traffic Engineer: Jignesh Thakkar, PE (TX, GA), PTOE	
Considered by Traffic Commission:	
Considered by City Council:	

9-19-24

Street View Link: https://www.google.com/maps/@34.5748849,-98.4005893,3a,75y,110.57h,82.12t/data=!3m8!1e1!3m6!1ssV6Hz1rIBLgD8VJDKVci-w!2e0!5s20240201T000000!6shttps:%2F%2Fstreetviewpixels-pa.googleapis.com%2Fv1%2Fthumbnail%3Fcb_client%3Dmaps_sv.tactile%26w%3D900%26h%3D600%26pitch%3D7.877984007423393%26panoid%3DsV6Hz1rIBLgD8VJDKVci-w%26yaw%3D110.5716698705998!7i16384!8i8192!5m1!1e1?coh=205410&entry=tu&g_ep=EgoyMDI0MDgyOC4wIKXMDSOASAFQAw%3D%3D

Recommendation: Salinas Drive is a loop. Install Yield sign on the western opening of the Salinas drive and deny the request to install Yield or Stop sign on the eastern opening of the Salinas Drive.

Install a Yield Sign on western opening of the SW Salinas Dr at 806 SW Sedalia Ave. According to OSHO interactive crash maps, there was a pedestrian crash in that intersection in April 2020. It appears in google street view that the view for the left-turning traffic on SW Salinas Dr may be obstructed by a tree. Installing a Yield on SW Salinas Dr may improve the safety of this intersection.

Deny the request to install a Yield or Stop sign on eastern opening of the Salinas Dr. The sight distance from the street view appears adequate. According to OSHO interactive crash maps, there has been no crash in that intersection in the last 12 months. Considering the estimated traffic volume and crash data, this intersection can run in “No Intersection Control” (ref Section 2B.09 and 2B.10 of the Manual of Uniform Traffic Control Devices (MUTCD)).

Deny the kids’ playing sign as it is not MUTCD compliant. According to Lawton city code 23-2-202, all traffic-control signs, signals and devices shall conform to the latest edition of the MUTCD.

Internal Analysis: Kids playing sign was not found from google street view on the west end of Sedalia Avenue as indicated in the request. Moreover, this sign is not MUTCD compliant.



TRAFFIC ISSUE REQUEST

ENGINEERING DEPARTMENT

Administrative Office

Mailing Address – 212 SW 9th Street, Lawton, OK 73501
Shipping Address – 2202 SW 3rd Street, Lawton, OK 73501
Phone (580) 581-3410 • Fax (580) 581-3421

www.cityof.lawton.ok.us

Requested by: Larry Commings	Request Number: 24-55
Address: 2502 SW Wolf Avenue	Date Request Received: August 22, 2024
City, State, Zip: Lawton, OK, 73505	Phone:
Request: No Parking signs. Citizens are parking in front of his house as they are waiting in line for the Food Bank. This will last for hours. It could become a hazard for emergency responders.	
Description of Intersection / Location:	
Accident Report Listing: N/A	
WARRANTS (MUTCD/City Code/City Policy): N/A	
Previous Action: N/A	
Previous Traffic Commission Recommendation(s): N/A	
Previous City Council Decision(s): N/A	
Action Recommended by Staff: Deny the request to install NO PARKING signs. City Code 23-6-603 prohibits parking to “block the driveway entrance to any abutting property”. There are already two “DO NOT BLOCK DRIVEWAY” signs on the two driveways of the citizen’s property. From Google Streetview imagery, these signs appear to be non-standard. If the problem persists, the appropriate city authority should be involved in a discussion with the food bank authority about their parking and circulation plan.	
Traffic Engineer: Jignesh Thakkar, PE (TX, GA), PTOE	
Considered by Traffic Commission:	
Considered by City Council:	

9-19-24

Street View Link:

https://www.google.com/maps/place/2502+SW+Wolf+St,+Lawton,+OK+73505/@34.5889537,-98.4248662,527m/data=!3m1!1e3!4m6!3m5!1s0x87ad1f6c185a80fd:0x2285af599bade7cd!8m2!3d34.5884608!4d-98.425163!16s%2Fg%2F11c4grjt7f?entry=tu&g_ep=EgoyMDI0MDgyNy4wIKXMDS0ASAFQAw%3D%3D

Recommendation: Deny the request to install NO PARKING signs.

[City Code 23-6-603](#) prohibits parking to “block the driveway entrance to any abutting property”. There are already two “DO NOT BLOCK DRIVEWAY” signs on the two driveways of the citizen’s property. From Google Streetview imagery, these signs appear to be non-standard. If the problem persists, the appropriate city authority should be involved in a discussion with the food bank authority about their parking and circulation plan.

[City Code 23-6-603](#) does not allow parked vehicle “to prohibit the free movement of fire department vehicles”. From the google map satellite view measurement, there is more than 12 ft width of street available on SW Wolf St for emergency vehicle after a standard car is parked on the street. This width should be adequate for emergency vehicles. According to [City Code 23-6-603](#), the maximum time permitted for loading or unloading is one hour.

The SW 24th St intersection close to the food bank has a “DO NOT BLOCK” intersection sign. It does not have any no “NO PARKING” sign.